

THIS DRAWING IS UNPUBLISHED. RELEASED FOR PUBLICATION JULY, 2005.
 © COPYRIGHT 2005 BY TYCO ELECTRONICS CORPORATION. ALL RIGHTS RESERVED.

LOC		DIST		REVISIONS			DATE	DWN	APVD
P	LTR	DESCRIPTION							
J	-	F2	REVISED ECR-07-030978			02APR08	C.D	H.S	

DIRECTION OFF TOP OF REEL

TAPE & REEL PACKAGE : AS SHOWN

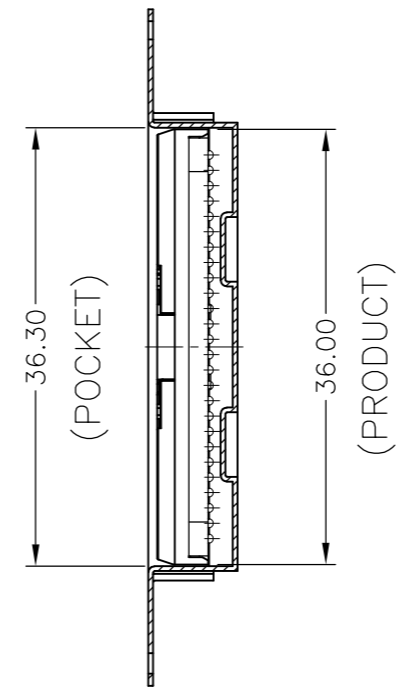
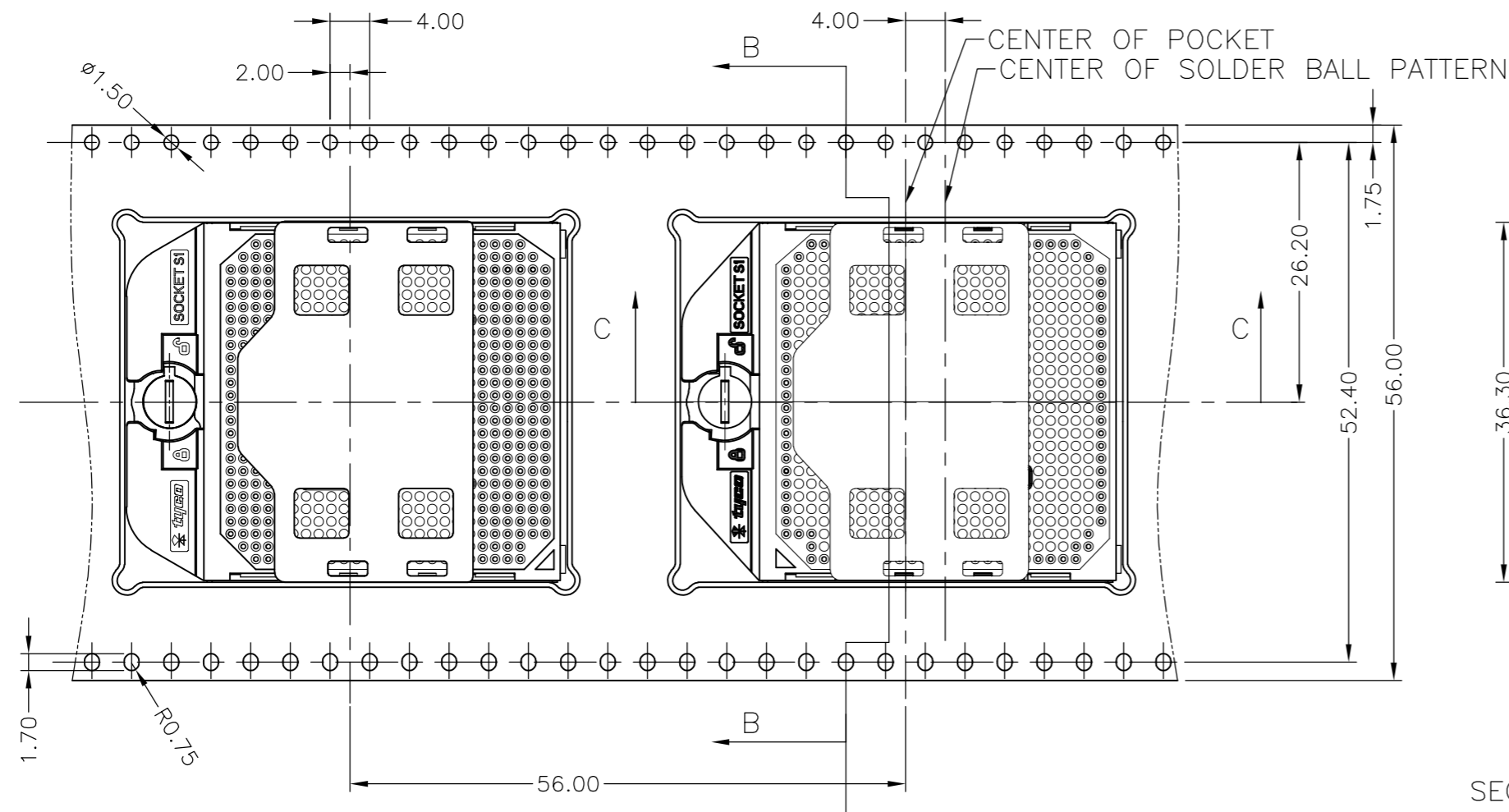

SECTION B-B

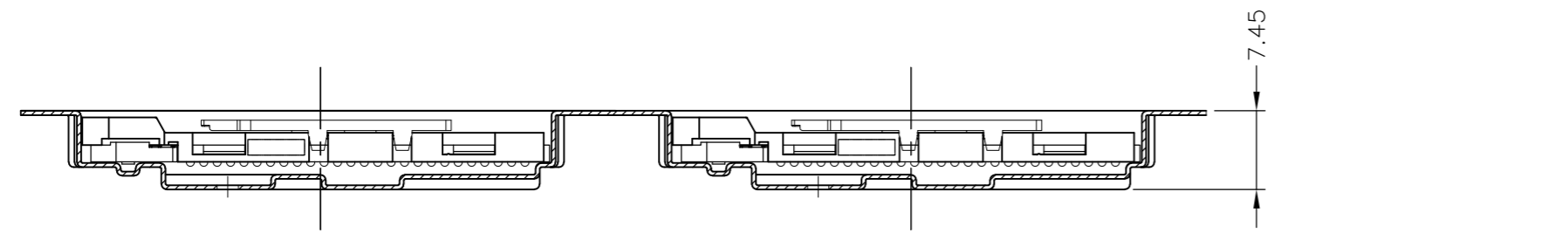
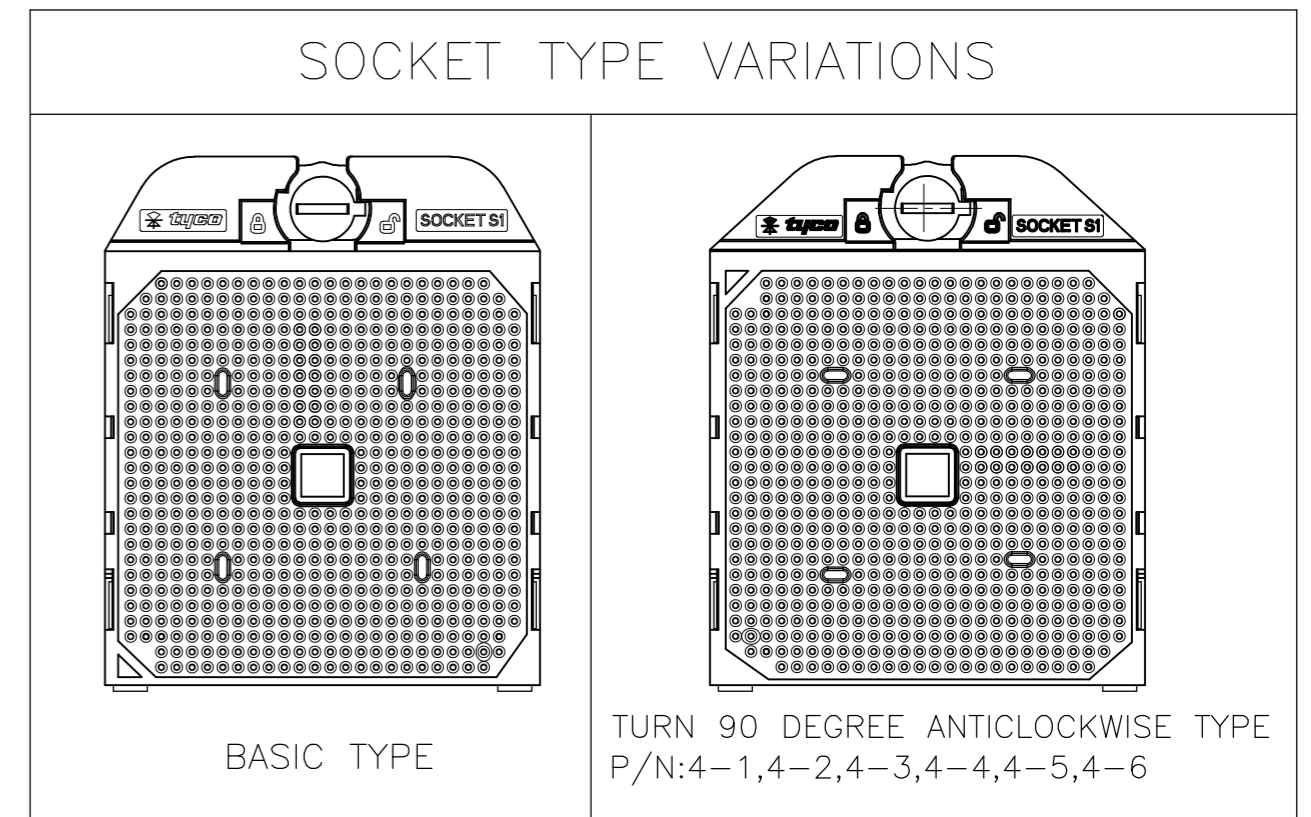

SECTION C-C

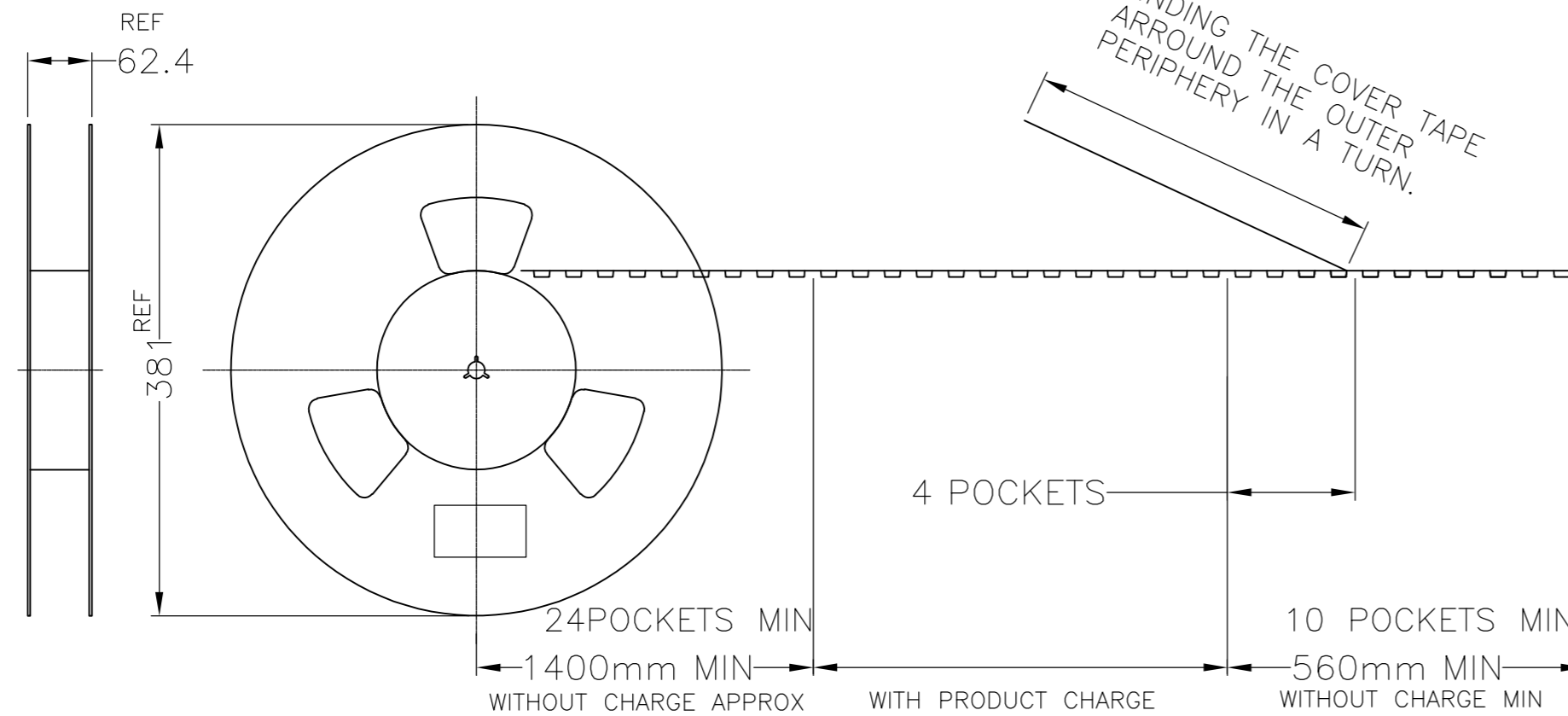

PRELIMINARY	640	TAPE & REEL	8.24	Pb-FREE	160	0.38um	4-1903401-6
PRELIMINARY	720	TRAY	8.24	Pb-FREE	18	0.38um	4-1903401-5
PRELIMINARY	640	TAPE & REEL	8.24	Pb-FREE	160	FLASH	4-1903401-4
PRELIMINARY	720	TRAY	8.24	Pb-FREE	18	FLASH	4-1903401-3
PRELIMINARY	640	TAPE & REEL	8.24	Pb-FREE	160	0.76um	4-1903401-2
PRELIMINARY	720	TRAY	8.24	Pb-FREE	18	0.76um	4-1903401-1
PRELIMINARY	640	TAPE & REEL	8.24	Pb-FREE	160	0.25um	1-1903401-6
PRELIMINARY	720	TRAY	8.24	Pb-FREE	18	0.25um	1-1903401-5
PRELIMINARY	640	TAPE & REEL	8.24	Pb-FREE	160	FLASH	1-1903401-4
PRELIMINARY	720	TRAY	8.24	Pb-FREE	18	FLASH	1-1903401-3
PRELIMINARY	640	TAPE & REEL	8.24	Pb-FREE	160	0.38um	1-1903401-2
PRELIMINARY	720	TRAY	8.24	Pb-FREE	18	0.38um	1-1903401-1
PRELIMINARY	640	TAPE & REEL	8.24	Sn-Pb	160	0.25um	1903401-6
PRELIMINARY	720	TRAY	8.24	Sn-Pb	18	0.25um	1903401-5
PRELIMINARY	640	TAPE & REEL	8.24	Sn-Pb	160	FLASH	1903401-4
PRELIMINARY	720	TRAY	8.24	Sn-Pb	18	FLASH	1903401-3
PRELIMINARY	640	TAPE & REEL	8.24	Sn-Pb	160	0.38um	1903401-2
PRELIMINARY	720	TRAY	8.24	Sn-Pb	18	0.38um	1903401-1
TOOLING STATUS	FINAL SHIPPING QTY PER CARTON BOX	PACKAGE TYPE	WEIGHT /SOCKET (g)	BALL TYPE	QTY PER PACKAGE	GOLD PL. TYPE	PART NO.

THIS DRAWING IS A CONTROLLED DOCUMENT.

DIMENSIONS: mm	TOLERANCES UNLESS OTHERWISE SPECIFIED:	DWN COREL WANG DEC1905	Tyco Electronics Kawasaki, Japan
		CHK S.HASHIMOTO 19DEC05	
		APVD H.SHIRAI 19DEC05	NAME
		PRODUCT SPEC	SOCKET ASSY
		108-60055	mPGA 638 POSITION
MATERIAL	FINISH	APPLICATION SPEC TEST REPORT SPEC 501-5767	SIZE CAGE CODE DRAWING NO RESTRICTED TO
		WEIGHT SEE TABLE	A2 00779 C=1903401
		CUSTOMER DRAWING	SCALE NTS SHEET 1 of 5 REV F2

THIS DRAWING IS UNPUBLISHED. RELEASED FOR PUBLICATION JULY ,2005.
 © COPYRIGHT 2005 BY TYCO ELECTRONICS CORPORATION. ALL RIGHTS RESERVED.

LOC		DIST		REVISIONS			
P	LTR	DESCRIPTION	DATE	DWN	APVD		
-	-	SEE SHEET 1	-	-	-		

TRAY PACKAGE : AS SHOWN

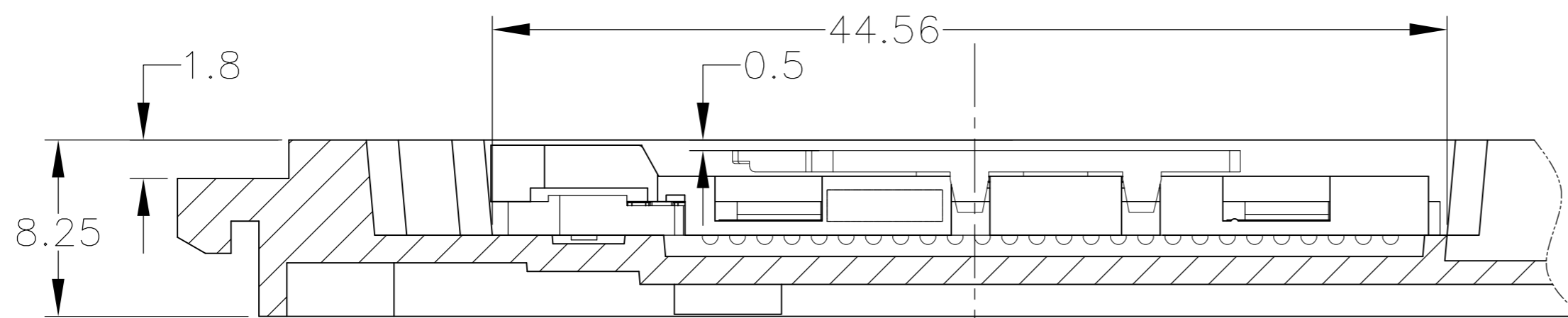
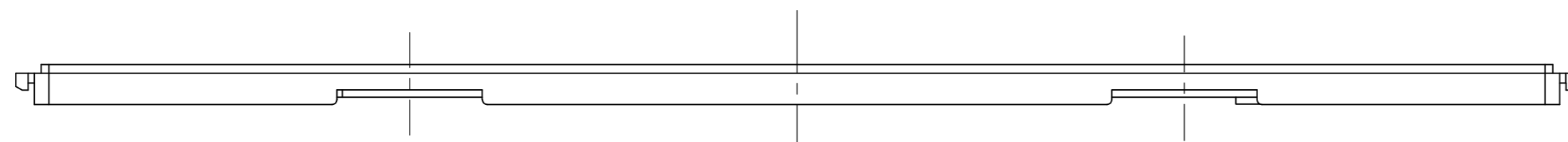
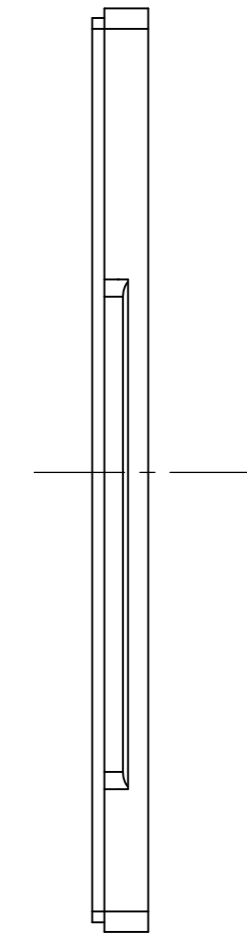
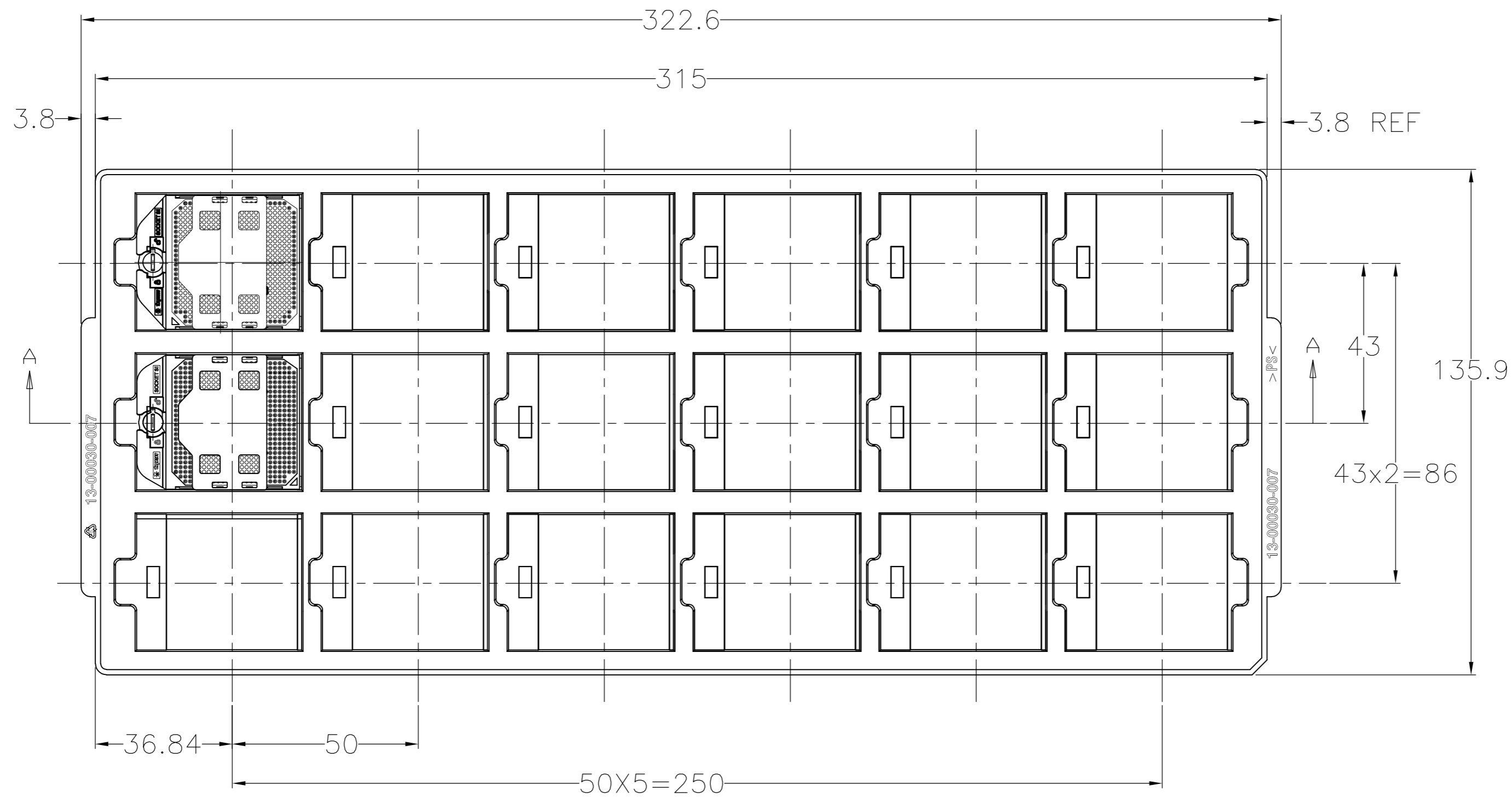

SECTION A-A

THIS DRAWING IS A CONTROLLED DOCUMENT.		DWN	Tyco Electronics AMP K.K. Kawasaki, Japan	
DIMENSIONS: mm		CHK	NAME SOCKET ASSY mPGA 638 POSITION	
TOLERANCES UNLESS OTHERWISE SPECIFIED: 0 PLC ± 0.5 1 PLC ± 0.5 2 PLC ± 0.5 3 PLC ± 0.5 4 PLC ± 0.5 ANGLES ± 3° FINISH SEE SHEET 1		APVD	SIZE	CAGE CODE
MATERIAL SEE SHEET 1		PRODUCT SPEC SEE SHEET 1	A2	00779
		APPLICATION SPEC SEE SHEET 1	DRAWING NO	RESTRICTED TO
		WEIGHT SEE SHEET 1	C=1903401	-
		CUSTOMER DRAWING	SCALE	SHEET
			NTS	2 of 5
				REV
				F2

LOC		DIST		REVISIONS			
P	LTR	DESCRIPTION	DATE	DWN	APVD		
		SEE SHEET 1					

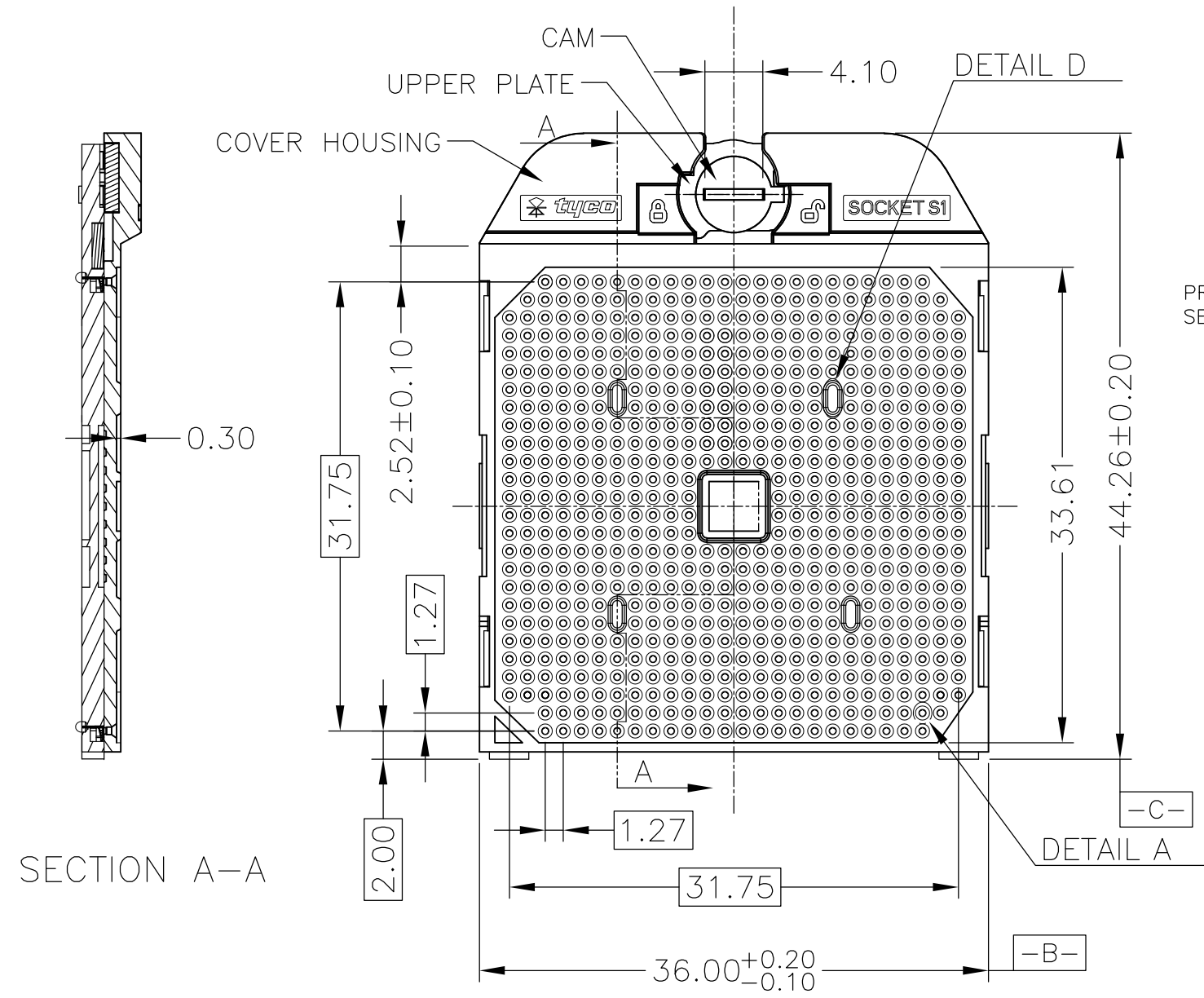

SHOW IN NON-ACTIVATED (OPEN) POSITION
TYCO SHIPPING CONDITION

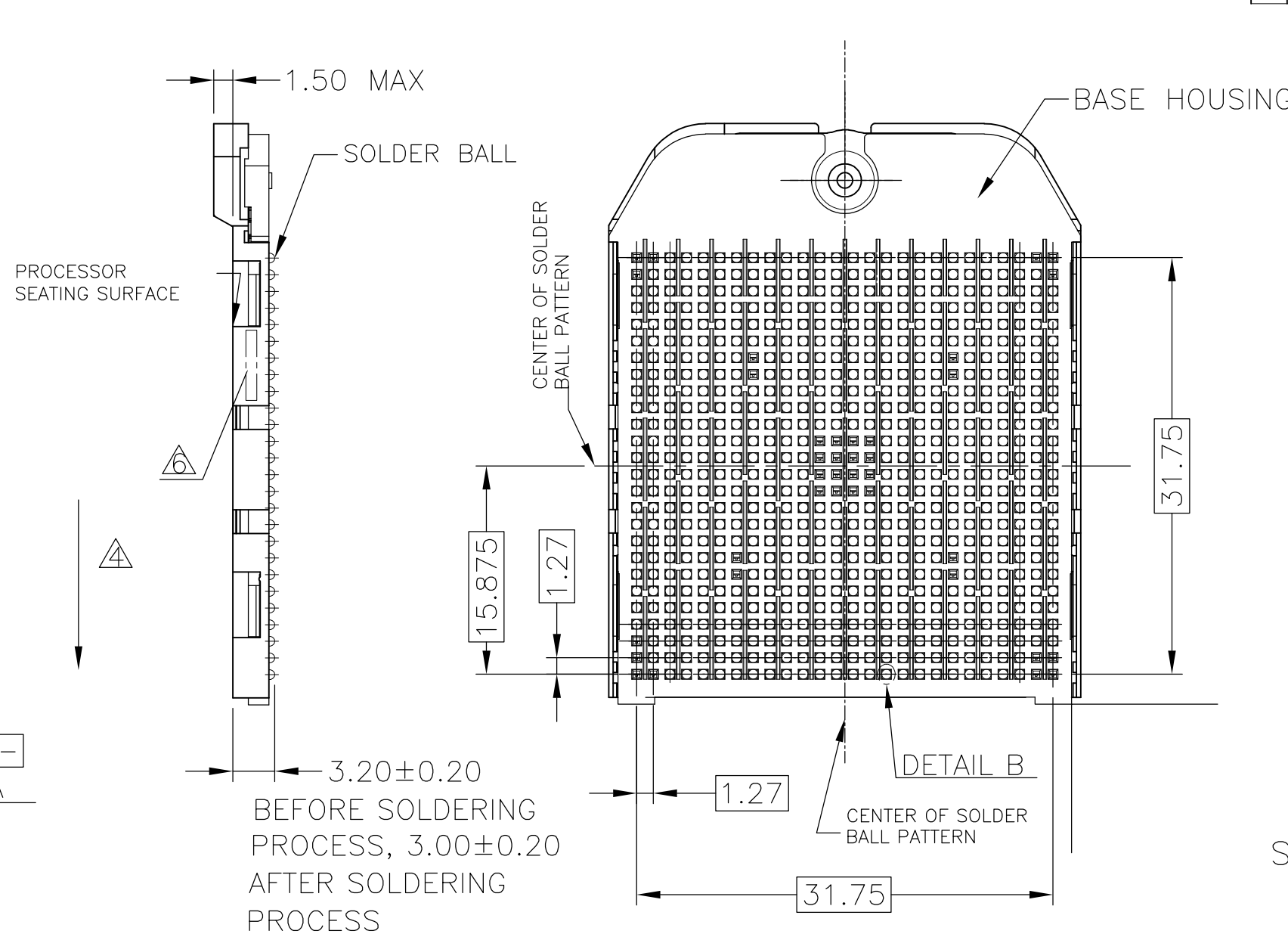
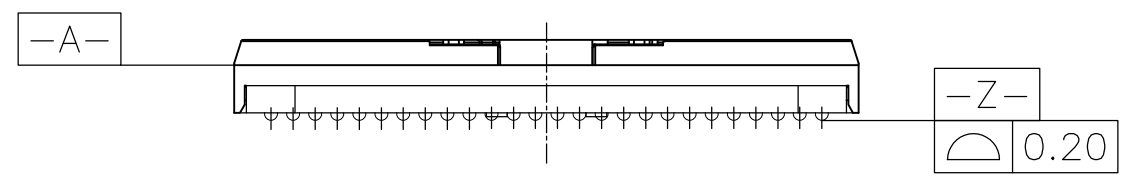

BEFORE SOLDERING PROCESS, 3.00±0.20
AFTER SOLDERING PROCESS

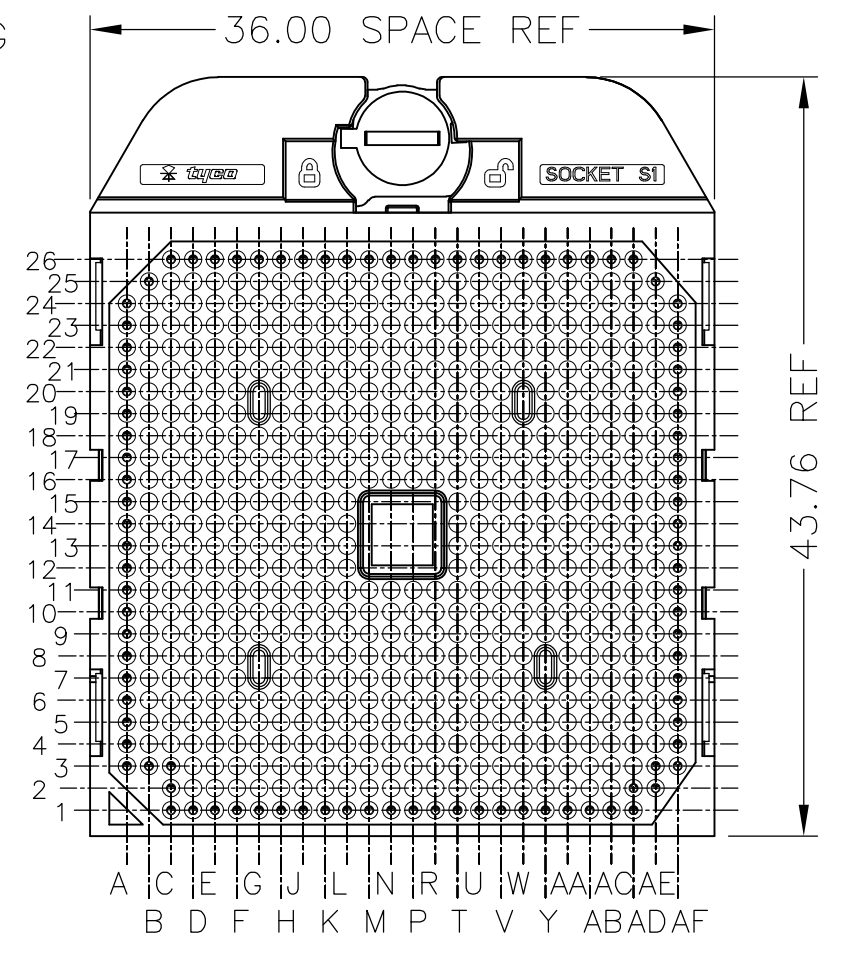

SHOW IN ACTIVATED (CLOSED) POSITION
WITH CIRCUIT SYMBOLS

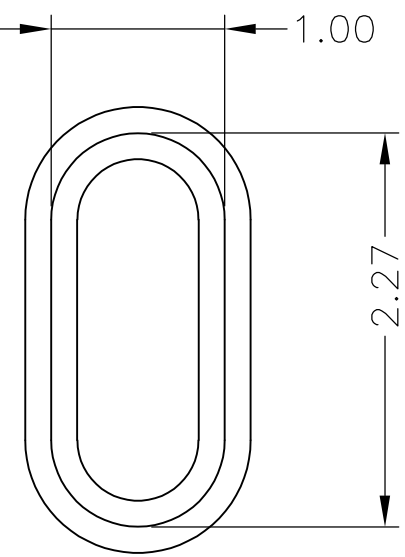

DETAIL B
SCALE 10:1

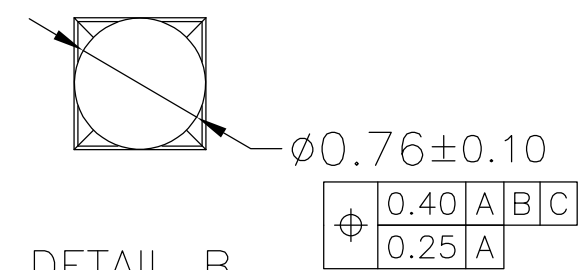

DETAIL B
SCALE 10:1

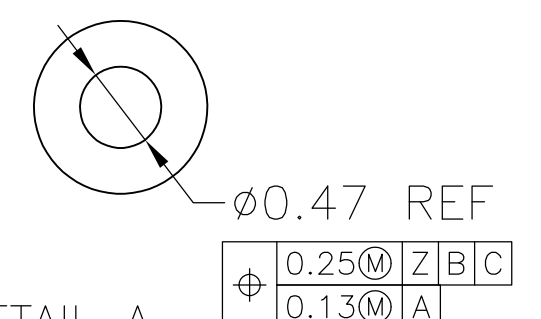

DETAIL A
SCALE 10:1

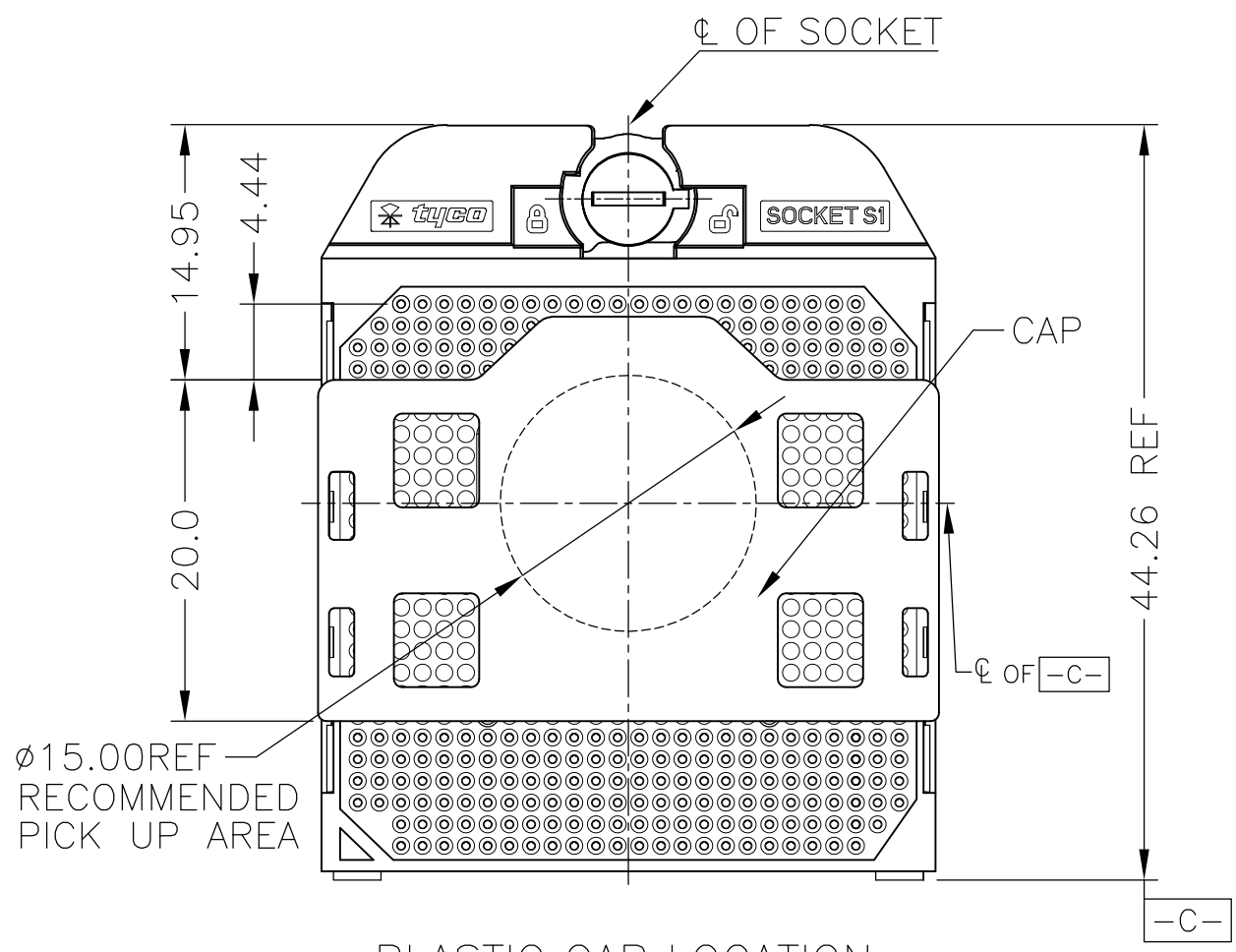

PLASTIC CAP LOCATION

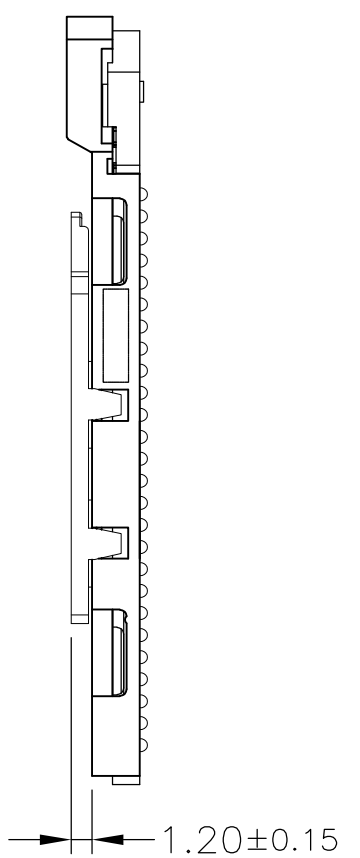

THIS DRAWING IS A CONTROLLED DOCUMENT.		DWN	Tyco Electronics Tyco Electronics AMP K.K. Kawasaki, Japan	
DIMENSIONS: mm		CHK	NAME	
TOLERANCES UNLESS OTHERWISE SPECIFIED:		APVD	SOCKET ASSY	
0 PLC ± 0.3		PRODUCT SPEC	mPGA 638 POSITION	
1 PLC ± 0.3		APPLICATION SPEC	SIZE	CAGE CODE
2 PLC ± 0.3		SEE SHEET 1	A2	00779
3 PLC ± 0.3		SEE SHEET 1	DRAWING NO	RESTRICTED TO
4 PLC ± 0.3		SEE SHEET 1	C=1903401	
ANGLES ± 3°		WEIGHT		
FINISH		CUSTOMER DRAWING	SCALE	SHEET
SEE SHEET 1			NTS	3 of 5

THIS DRAWING IS UNPUBLISHED. RELEASED FOR PUBLICATION JULY ,2005.
 © COPYRIGHT 2005 BY TYCO ELECTRONICS CORPORATION. ALL RIGHTS RESERVED.

LOC	DIST	REVISIONS			
P	LTR	DESCRIPTION	DATE	DWN	APVD
-	-	SEE SHEET 1	-	-	-

TURN 90 DEGREE ANTI-CLOCKWISE

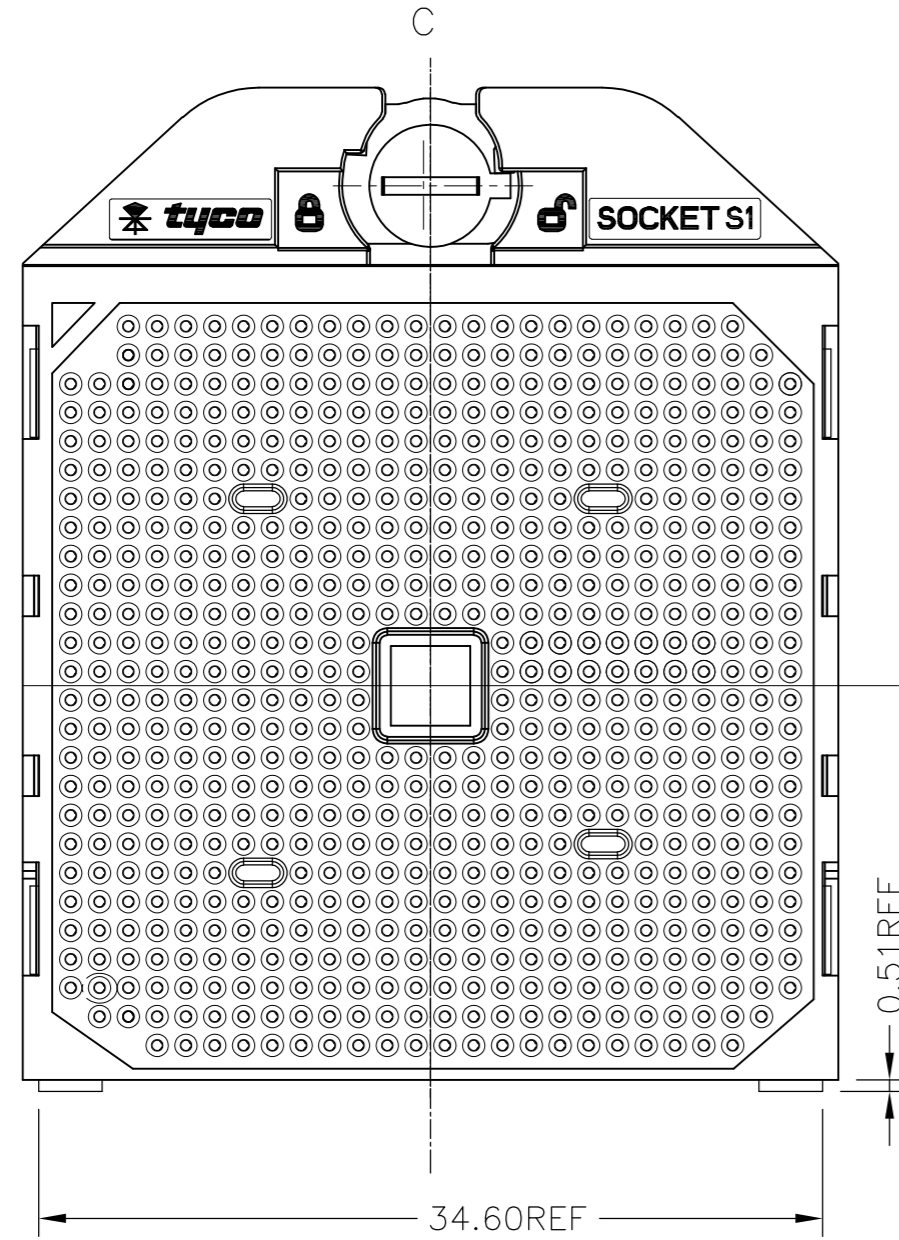

SHOW IN NON-ACTIVATED(OPEN) POSITION

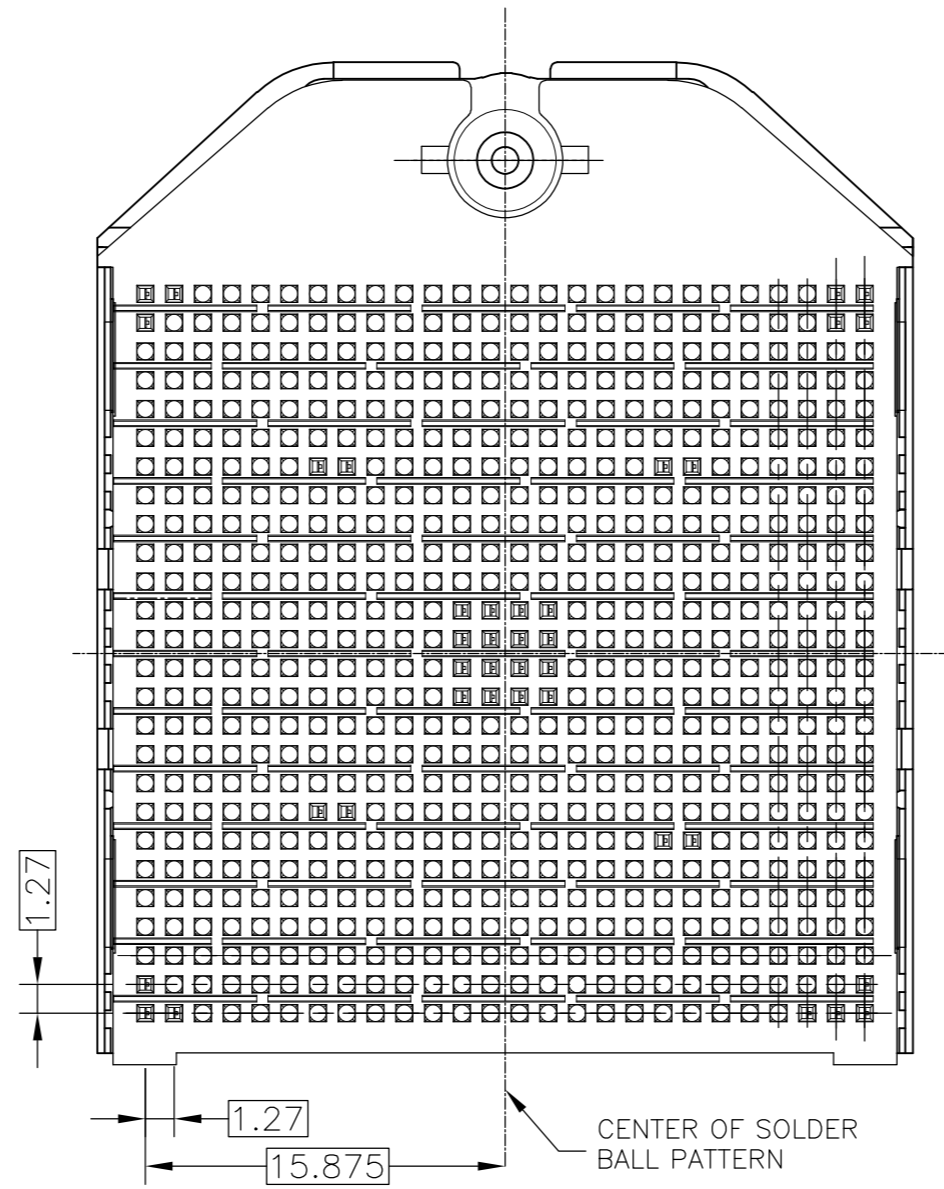

BOTTOM VIEW
 SHOW IN NON-ACTIVATED(OPEN) POSITION

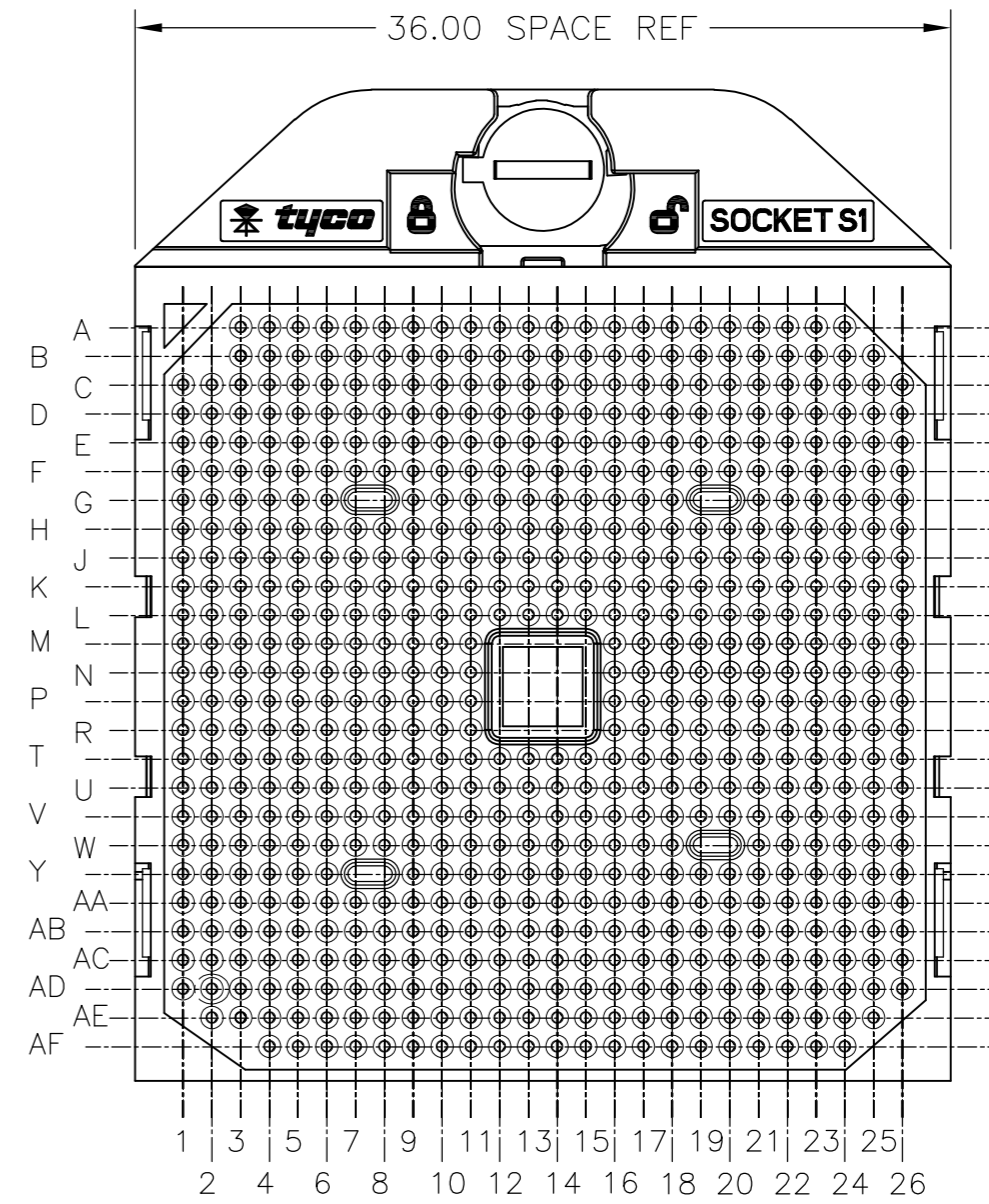

SHOW IN ACTIVATED(CLOSED) POSITION
 WITH CIRCUIT SYMBOLS

P/N:4-1,4-2,4-3,4-4,4-5,4-6

THIS DRAWING IS A CONTROLLED DOCUMENT.		DWN	Tyco Electronics Tyco Electronics AMP K.K. Kawasaki, Japan	
DIMENSIONS: mm		CHK	NAME SOCKET ASSY mPGA 638 POSITION	
TOLERANCES UNLESS OTHERWISE SPECIFIED: 0 PLC ± 0.3 1 PLC ± 0.3 2 PLC ± 0.3 3 PLC ± 0.3 4 PLC ± 0.3 ANGLES ± 3°		APVD	PRODUCT SPEC SEE SHEET 1	
MATERIAL SEE SHEET 1		FINISH SEE SHEET 1	APPLICATION SPEC SEE SHEET 1	RESTRICTED TO -
		WEIGHT SEE SHEET 1	SIZE A2	CAGE CODE 00779
		CUSTOMER DRAWING	DRAWING NO C=1903401	SCALE NTS
			SHEET 4 of 5	REV F2

THIS DRAWING IS UNPUBLISHED. RELEASED FOR PUBLICATION JULY, 2005.
 © COPYRIGHT 2005 BY TYCO ELECTRONICS CORPORATION. ALL RIGHTS RESERVED.

LOC	DIST	REVISIONS			
P	LTR	DESCRIPTION	DATE	DWN	APVD
-	-	SEE SHEET 1	-	-	-

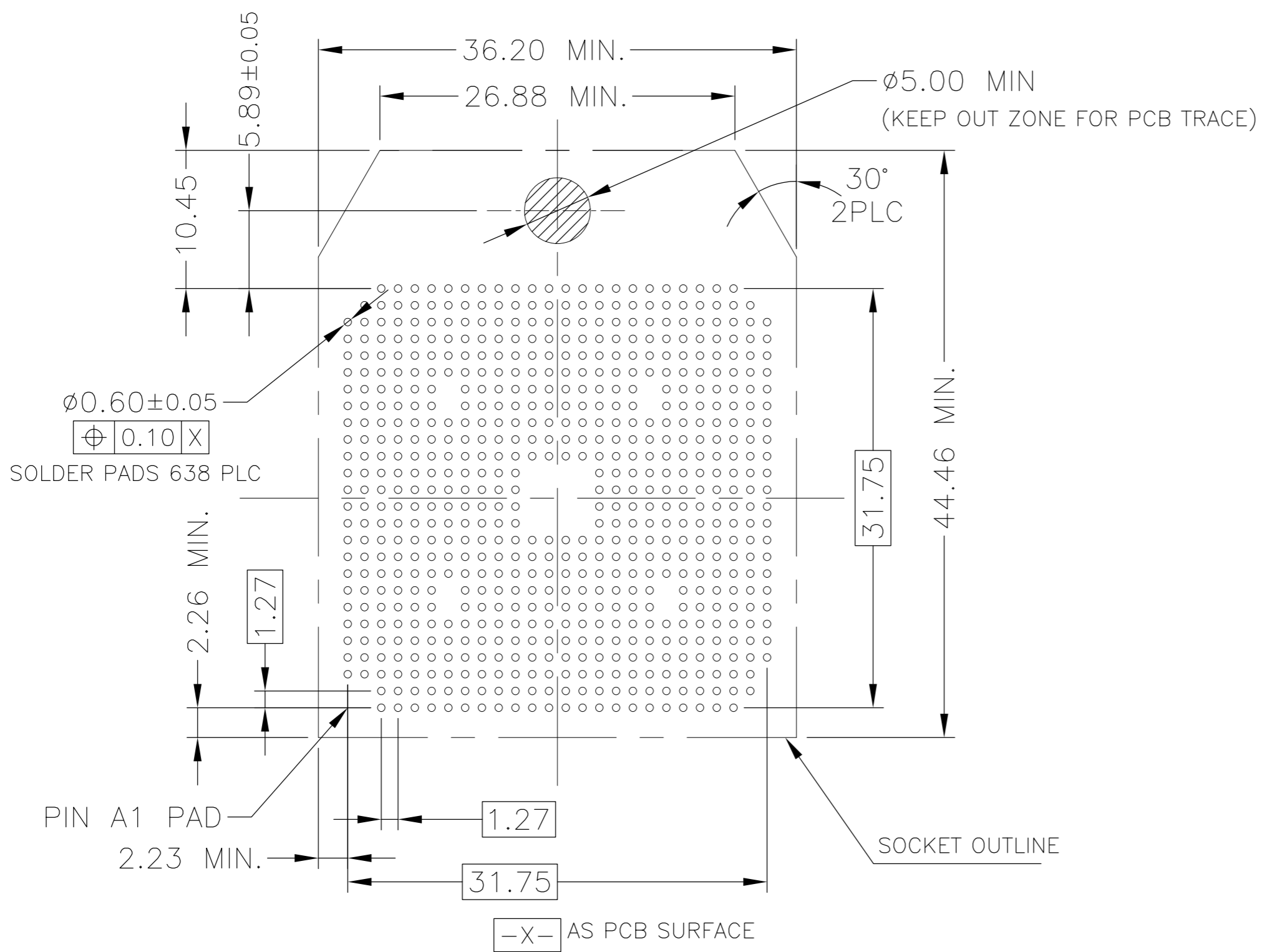

REFERENCE DIMSION OF PCB LAYOUT(MOUNTING SIDE)
NORMAL TYPE

- 1 MATERIAL
 BASE HOUSING: THERMO-PLASTIC UL94V-0 BLACK
 COVER HOUSING: THERMO-PLASTIC UL94V-0 BLACK
 CONTACT: COPPER ALLOY
 CAP: THERMO-PLASTIC UL94V-0 BLACK
 BALL : Sn-Pb REPRESENTS TIN/LEAD ALLOY
 Pb-FREE REPRESENTS TIN/SILVER/COPPER ALLOY
 OTHERS: STAINLESS STEEL & CARBON STEEL
- 2 FINISH
 GOLD PLATE AT CONTACT AREA OVER NICKEL PLATE.
- 3 USER INTERFACE
 A) FLAT HEAD SCREW DRIVER TO ACTUATE
 B) CLOCKWISE TO "LOCK", COUNTER-CLOCKWISE TO "OPEN"
 C) 180 DEGREE BETWEEN "LOCK" AND "OPEN"
- 4 ACTUATION DIRECTION AS SHOWN. 0.65 NOMINAL PROCESSOR MOVEMENT.
- 5 SOCKET WILL ACCEPT PGA PACKAGE WITH PIN DIAMETER OF 0.3±0.025 AND 2.03±0.08 PIN LENGTH. PLATED WITH GOLD OVER NICKEL.
- 6 DATE CODE AREA

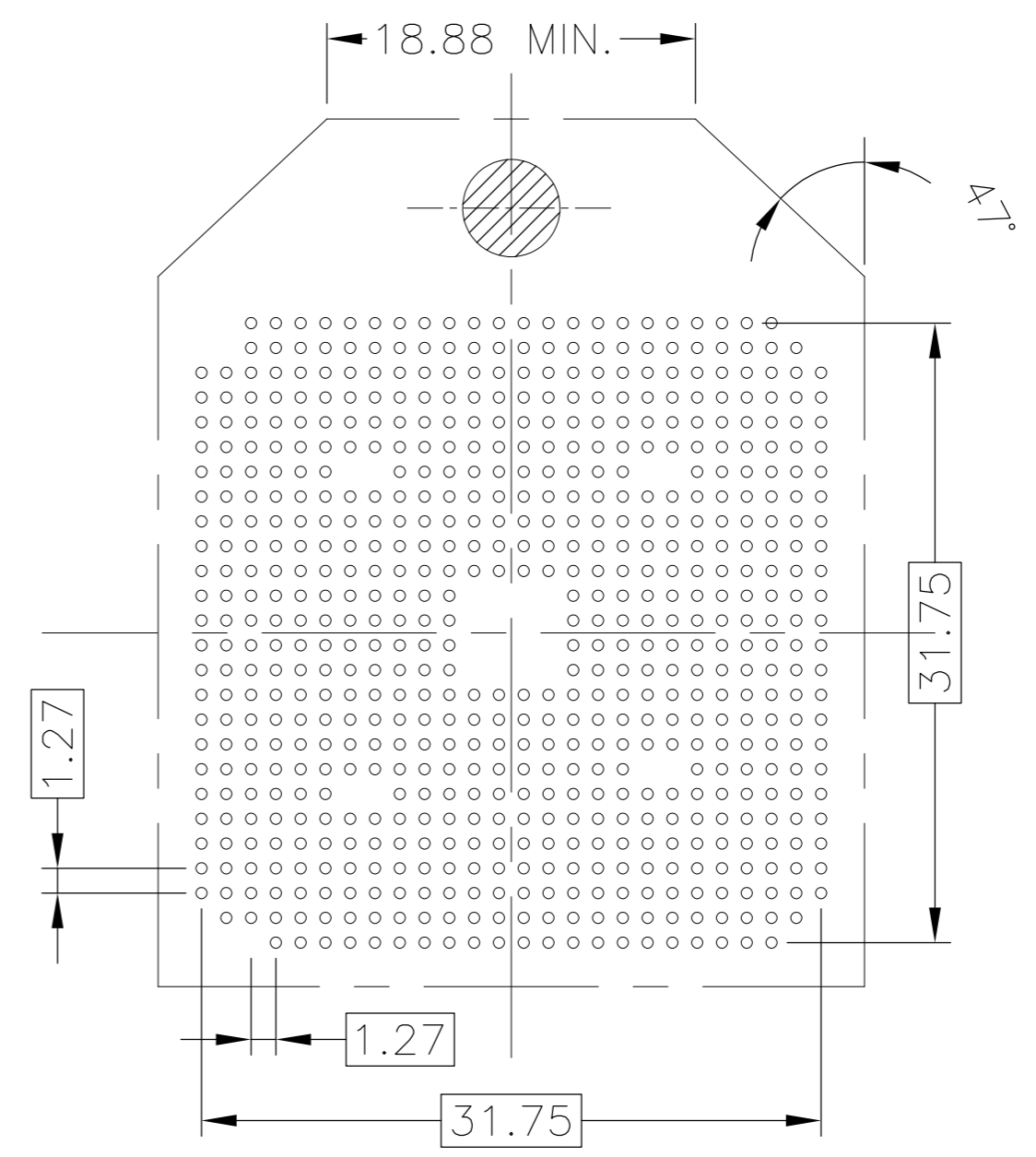

REFERENCE DIMSION OF PCB LAYOUT(MOUNTING SIDE)
TURN 90° ANTICLOCKWISE TYPE
(DIMENSION IS SAME WITH NORMAL TYPE UNLESS OTHERWISE SPECIFIED)

THIS DRAWING IS A CONTROLLED DOCUMENT.		DWN	Tyco Electronics AMP K.K. Kawasaki, Japan	
DIMENSIONS: mm		CHK	NAME SOCKET ASSY mPGA 638 POSITION	
TOLERANCES UNLESS OTHERWISE SPECIFIED:		APVD	SIZE	CAGE CODE
0 PLC ± 0.5		PRODUCT SPEC	A2	00779
1 PLC ± 0.5		APPLICATION SPEC	DRAWING NO	RESTRICTED TO
2 PLC ± 0.5		SEE SHEET 1	C=1903401	-
3 PLC ± 0.5		SEE SHEET 1	SCALE	SHEET
4 PLC ± 0.5		SEE SHEET 1	NTS	5 OF 5
ANGLES ± 3°		WEIGHT	REV	F2
MATERIAL	FINISH	CUSTOMER DRAWING		
SEE SHEET 1	SEE SHEET 1			